

Capstan CP Lead Safe^{1/2} Turn Wall Top Ass Child Safety Tap

PRODUCT CODE:

- 175.91.00.03

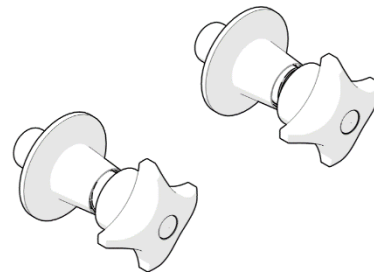

SPECIFICATIONS

- The Galvin Engineering Safety Tap has been devised to add another precautionary aid against children tampering with hot water. Once the flow is set, young children are unable to tamper with the flow until reset by an adult.
- The main body is made of solid dezincification resistant (DR) brass rod.
- SBA's includes brass ceramic disc component, with red and blue indicator.
- Lead Safe™ brass construction*

IMPORTANT: All taps are tested in accordance with AS/NZS 3718 and leave our premises in good working order.

*As 'lead free' is not currently defined by law in Australia and New Zealand, we have based our definition of Lead Safe™ on the requirements of Sec. 1417 of the USA's Safe Drinking Water Act (SDWA) and the relevant US standards NSF61 / NSF372. The SDWA defines 'lead free' as "not more than a weighted average of 0.25% lead when used with respect to the wetted surface of pipes, pipe fittings, plumbing fittings and fixtures".

WARNINGS: Special attention to be paid on notes, photos, image, or drawings of assembly steps marked with the warning symbol.



TECHNICAL DATA

Inlet	G 5/8" BSP - Male	
Outlet	N/A	
Headwork	Ceramic Disc	
Working Pressure Range (kPa)	Min	50
	Max	500
Working Temperature Range (°C)	Min	5
	Max	65
Nominal Flow Rate (LPM)	N/A	
Finish	Chrome	
NOTE: Galvin Engineering continually strive to improve their products. Specifications may change without notice.		

TOOLS REQUIRED

Product Installation Guidelines

Version 1, 7 July 2023, Page 2 of 5

- Power drill
- Spanner and hex key
- Thread tape

PRE-INSTALLATION - MOUNTING DETAILS

Note: Before installation, all lines must be flushed. Galvin Engineering recommends the installation of strainers and pressure reducing valves to ensure clean consistent supply. Debris or poor water quality could cause the push button to seize or fail to seal.

Wall body

- Check that the existing valve body complies to AS/NZS 3718. Inwall body must be G5/8" FI and body should be between 0 and 15mm behind the finished wall surface.

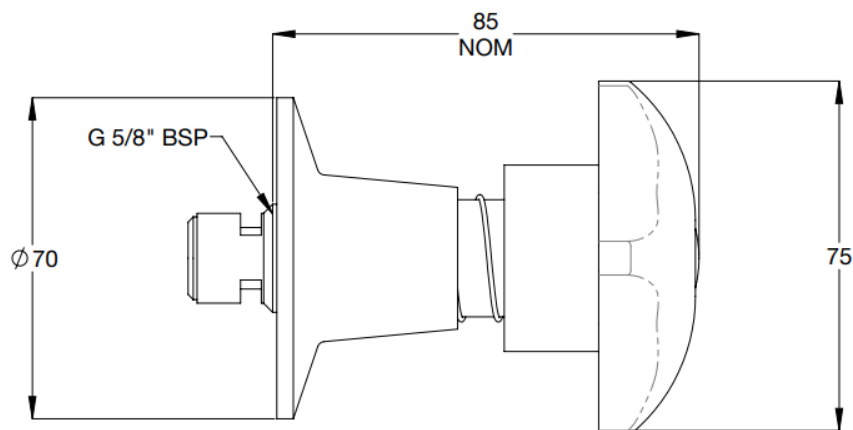
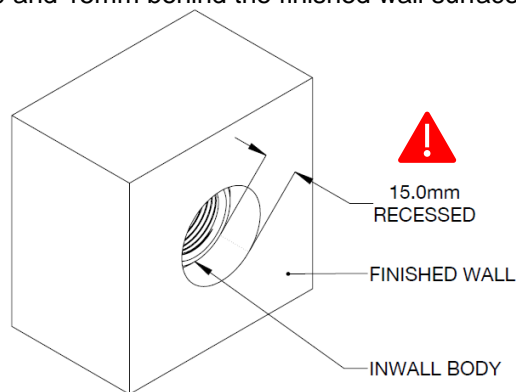

INSTALLATION

INSTALLATION COMPLIANCE: Galvin Engineering products must be installed in accordance with these installation instructions and in accordance with AS/NZS 3500, the PCA and your local regulatory requirements. Water and/or electrical supply conditions must also comply to the applicable national and/or state standards. Failing to comply with these provisions shall void the product warranty and may affect the performance of the product.

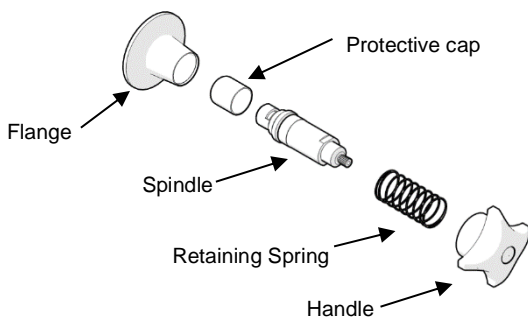

1. Disassembly

- Remove the protective cap, handle, dress flange and the retaining spring from the assembly. Unscrew the 1/2 turn ceramic headpart from the threaded sleeve assembly.

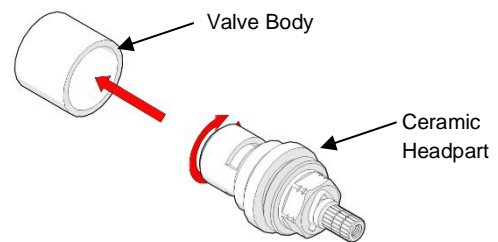

2. Fit wall flange

- Screw ceramic headpart into the valve body by hand, tighten using a 17mm spanner.
- Refit threaded sleeve and spindle.
- The 1/2 turn ceramic headpart MUST be fitted into the wall body prior to refitting the threaded sleeve and spindle. DO NOT tighten headpart by using the spindle or the threaded sleeve.**

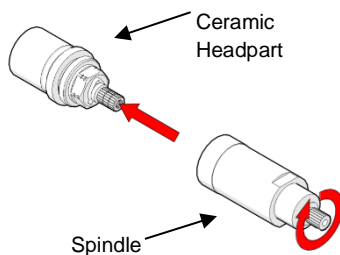

3. Fit wall flange and handle

- Re-fit the safety tap sleeve assembly, then fit the dress flange. Insert the spring into the dress flange and fit the handle and button over the top.

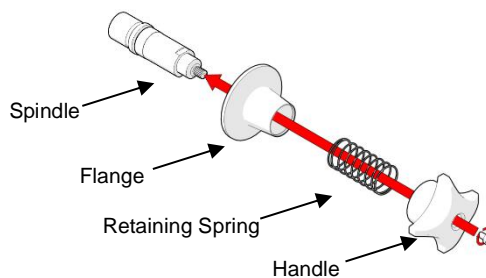

3. Fit wall flange and handle

- Ensure the spindle is in the closed position and firmly press the handle onto the spindle in the desired orientation.
- Check operation of handle. They should turn freely for a full 1/2 turn.
- Once handle is secure; fit the appropriate water temperature indicator.
- Secure the handle in position using the supplied washer and stainless steel cap screw.

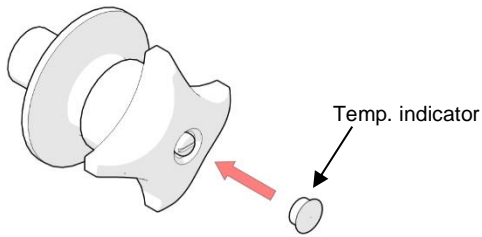

4. Fit water temperature indicator

- Once handle is secure; fit the appropriate water temperature indicator.



5. Testing

Check the operation of the unit and inspect for any leaks.

TROUBLESHOOTING

PROBLEM	CAUSE	RECTIFICATION
Taps are dripping water	Ceramic discs are worn or damaged	Remove and inspect SBA. Remove debris and/or replace SBA if damaged.
	Tap seat is damaged	Refurbish tap seat using a reseating tool.
Water is not flowing from tap	Water is turned off	Turn water on
	Aerator or flow regulator is blocked by debris	Remove aerator and/or flow regulator from tap and remove debris. Install an inline strainer.
	Obstruction on spout	Check if there are obstructions hindering the water flow in the spout and take it out.
Handle is loose	Screw has come loose	Tighten handle screw

SERVICE AND MAINTENANCE

1. Turn off the water supply and turn on the tap handle to drain water from the bodies.
2. Remove the temperature indicator from the handle.
3. Remove the handle from the tap.
4. Unscrew the ceramic headpart from the body.
5. Check the o-ring on the ceramic headpart for wear and damage. Replace if required.
6. Clean the headpart and the body of any debris.
7. Replace the cartridge and hand-tighten back into the body.
8. Follow the product installation guidelines for the relevant product re-assembly method.

WARRANTY

The warranty set forth herein is given expressly and is the only warranty given by the Galvin Engineering Pty Ltd. With respect to the product, Galvin Engineering Pty Ltd makes no other warranties, express or implied. Galvin Engineering Pty. Ltd. hereby specifically disclaims all other warranties, express or implied, including but not limited to the implied warranties of merchantability and fitness for a particular purpose.

Galvin Engineering Pty Ltd products are covered under our manufacturer's warranty available for download from www.galvinengineering.com.au Galvin Engineering Pty Ltd expressly warrants that the product is free from operational defects in workmanship and materials for the warranty period as shown on the schedule in the manufacturer's warranty. During the warranty period, Galvin Engineering will replace or repair any defective products manufactured by Galvin Engineering without charge, so long as the terms of the Manufacturer's warranty are complied with.

The remedy described in the first paragraph of this warranty shall constitute the sole and exclusive remedy for breach of warranty, and Galvin Engineering Pty Ltd shall not be responsible for any incidental, special or consequential damages, including without limitation, lost profits or the cost of repairing or replacing other property which is damaged if this product does not work properly, other costs resulting from labour charges, delays, vandalism, negligence, fouling caused by foreign material, damage from adverse water conditions, chemical, electrical or any other circumstances over which Galvin Engineering has no control. This warranty shall be invalidated by any abuse, misuse, misapplication, improper installation or improper maintenance or alteration of the product.

Within Australia: 1300 514 074 Outside Australia: P: +61 (0)8 9338 2344

F: +61 (0)8 9338 2340

sales@galvinengineering.com.au

www.galvinengineering.com.au

ABN: 78 008 719 382

PERTH | SYDNEY | MELBOURNE | BRISBANE | ADELAIDE

